

# Alpha<sup>®</sup> Ecoguard Type G Dust Collection Cover Instruction Manual

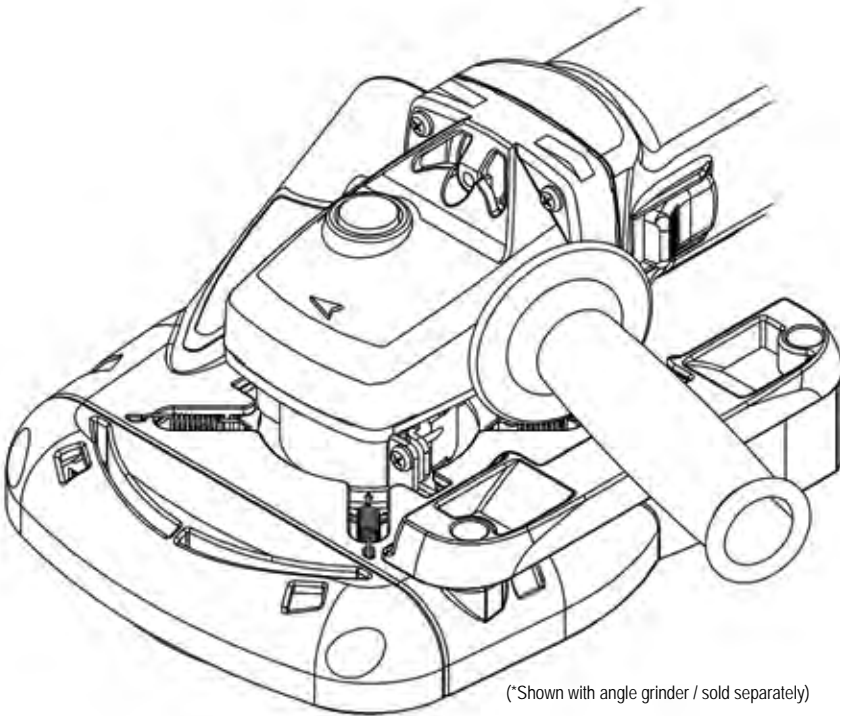

(\*Shown with angle grinder / sold separately)

Part No: ECOGRDGR  
Version 3

 **Alpha Professional Tools**<sup>®</sup>

103 Bauer Drive, Oakland, NJ 07436 • 800-648-7229 • Fax: 800-286-0114  
[www.alpha-tools.com](http://www.alpha-tools.com)

# TABLE OF CONTENTS



Introduction.....	3
About the Symbols .....	3
Ecoguard Type G Overview.....	4
Contents.....	4
Ecoguard Type G Other Connectors and Spacers.....	5
Installing the Dust Collection Cover.....	6
Installing the Connector.....	7
Installing the Flex® Connector .....	8
Mounting the Grinding Cup Wheel to the Grinder .....	9
Attachable Grinders.....	10
Grinding Applications.....	11
Surface Grinding .....	11
Wall Grinding.....	12
Attaching the Dust Collector .....	13
Ecoguard Type G Schematic.....	14
Ecoguard Type G Parts List.....	15

## INTRODUCTION

Thank you for purchasing the Alpha® Ecoguard Type G Dust Collection Cover. The Ecoguard Type G must be used with a vacuum, or other dust collection system. To ensure correct use, read this Instruction Manual and the Instruction Manual for the power tool and follow the operating instructions. Keep this manual in a place where operators can access it easily whenever necessary!

### ► ABOUT THE SYMBOLS

According to the hazard level, all safety notes in this manual are classified into “DANGER”, “WARNING”, and “CAUTION”.

-  **DANGER!** Death or serious personal injury is imminent when handling this Dust Collection Cover incorrectly.
-  **WARNING!** There is a possibility of death or serious personal injury when handling this Dust Collection Cover incorrectly.
-  **CAUTION!** There is a possibility of personal injury or property damage when handling this Dust Collection Cover incorrectly.

Note: In some situations, failing to observe WARNING notes could result in death or serious personal injury. Be sure to read and observe the safety notes to ensure safety and correct use of the Dust Collection Cover.

### ► PRECAUTIONS FOR USING DUST COLLECTION COVER

1. The Dust Collection Cover is for use with a 4.5" (115mm), 5" (125mm) or 6" (150mm) high-speed angle grinder.
2. The Dust Collection Cover is designed for grinding concrete, stone and other masonry products. Do not use when cutting metal or other materials.
3. The Dust Collection Cover is solely designed for use with a diamond cup wheel. Do not use with any other type of blade such as a grindstone or chip saw.
4. Always check the Dust Collection Cover for damage, cracks or deformation before starting work. Do not use the Dust Collection Cover if it is damaged, cracked or bent as this could cause injury.
5. Always wear eye protection, dust mask, nonskid safety shoes, hard hat and hearing protection.
6. Keep the Dust Collection Cover away from gasoline, thinner, petroleum and paraffin.
7. The supplied connector may not connect securely to every high-speed angle grinder. In this case, do not use the Dust Collection Cover.

# ECOGUARD TYPE G OVERVIEW

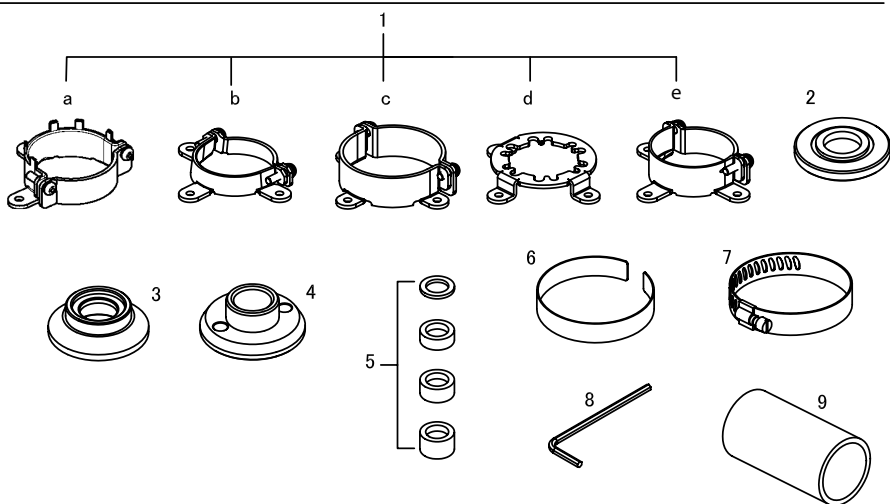
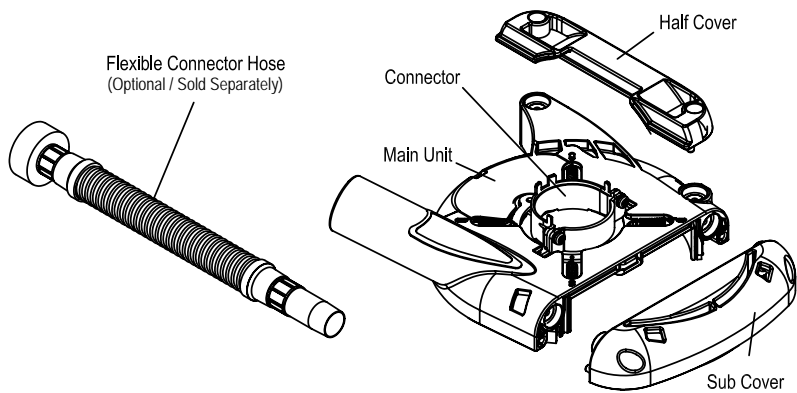

## ► CONTENTS:

1. Connectors:
  - a. Makita®, Milwaukee® & Bosch®: Preset to Ecoguard G
  - b. Hitachi®
  - c. Bosch® / Metabo®
  - d. Flex®
  - e. Dewalt®
2. Base Flange
3. Inner Flange
4. Lock Nut
5. Spacers (T2.5, T5.0, T7.0, T9.4 / mm)
6. Collar (for Metabo®)
7. Stainless Steel Hose Band
8. Hex. Wrench
9. Rubber Hose Connector

# ECOGUARD TYPE G SPACERS AND CONNECTORS

MAKITA®/MILWAUKEE®/BOSCH®	HITACHI®
<p>BOSCH / 1830 Slim only</p> <p>500028 (Preset)</p> <ul style="list-style-type: none"> <li>500011 / T2.5</li> <li>500012 / T5.0</li> <li>500013 / T7.0</li> <li>500014 / T9.4</li> </ul> <p>500029</p> <p>Original Lock Nut</p>	<p>500003</p> <ul style="list-style-type: none"> <li>500011 / T2.5</li> <li>500012 / T5.0</li> <li>500013 / T7.0</li> <li>500014 / T9.4</li> </ul> <p>500029</p> <p>Original Lock Nut</p>
DEWALT®	BOSCH® / METABO®
<p>500073</p> <ul style="list-style-type: none"> <li>500011 / T2.5</li> <li>500012 / T5.0</li> <li>500013 / T7.0</li> </ul> <p>500007</p> <p>500008</p>	<p>500022 METABO only</p> <p>500004</p> <ul style="list-style-type: none"> <li>500011 / T2.5</li> <li>500012 / T5.0</li> <li>500013 / T7.0</li> <li>500014 / T9.4</li> </ul> <p>500029</p> <p>Original Lock Nut</p>
FLEX®	
<p>500071</p> <ul style="list-style-type: none"> <li>500011 / T2.5</li> <li>500012 / T5.0</li> <li>500013 / T7.0</li> <li>500014 / T9.4</li> </ul> <p>500029</p> <p>Original Lock Nut</p>	

\* Original indicates Lock Nut included with Tool.

## INSTALLING THE DUST COLLECTION COVER

 **WARNING!**

1. Be sure to turn off the high-speed angle grinder and remove the plug from the electrical outlet before attaching and installing the Dust Collection Cover.
2. Take the Guard off from the Grinder.

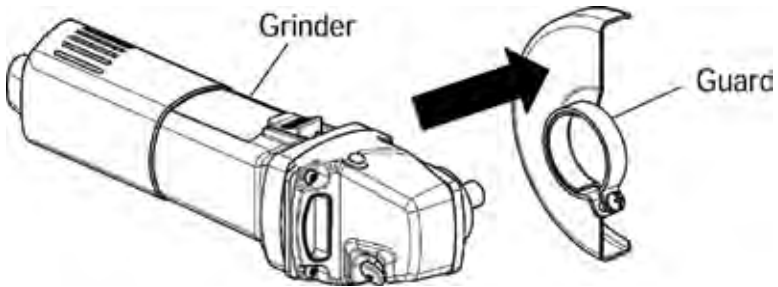

(Fig.1)

3. Make sure the Dust Collection Cover is securely attached, otherwise it may come loose which could cause injury.
4. If you installed the Dust Collection Cover to a high-speed angle grinder but the connector is loose and cannot be securely attached, do not use the Dust Collection Cover. Using it in this state could cause injury.

## ► INSTALLING THE CONNECTOR

If a different Connector is needed, exchange the connector per the following instructions.

1. Loosen the Screws.
2. Take the front of the Connector Assembly off.

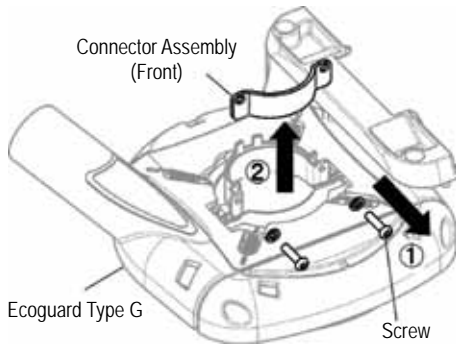

(Fig.2)

3. Loosen the Flat Head Screws using the Hex Wrench.
4. Take the back of the Connector Assembly off.
5. Replace with other Connector.
6. Place in the other Connector Assembly.

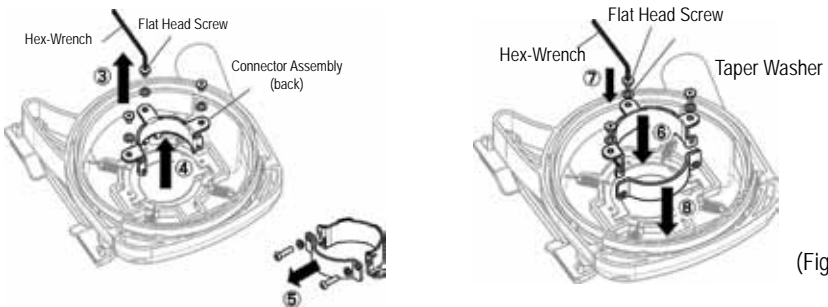

(Fig.3)

7. Tighten Flat Head Screws with Hex Wrench.  
(DO NOT forget to insert Taper Washers)

8. Tighten the Screws  
(DO NOT forget to insert Spring Washers)

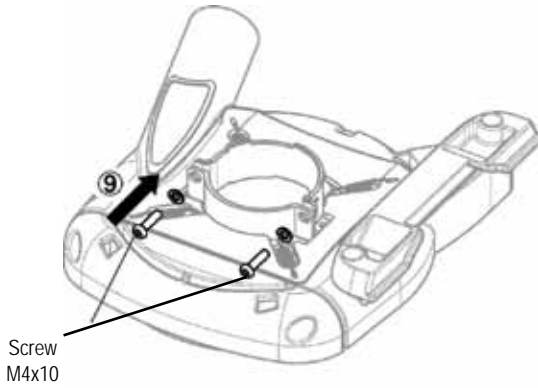

(Fig.4)

**⚠ CAUTION!**

The Dust Collection Cover is solely designed for use with a grinding cup wheel. Do not use with any other type of blade, such as a cutoff or tip saw blades.

► INSTALLING THE FLEX® CONNECTOR

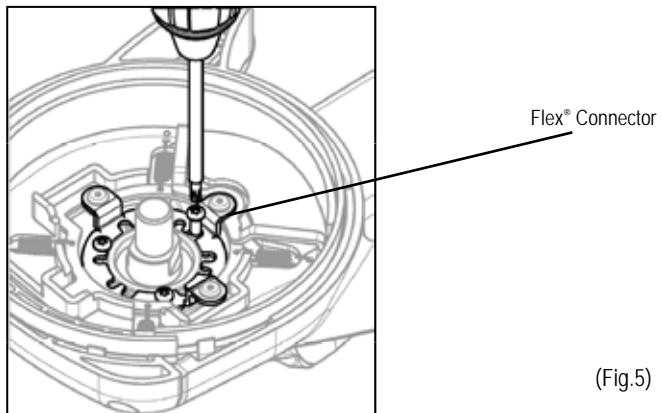

(Fig.5)

NOTE: The Flex® connector is connected directly to the Grinder, as shown in Figure 5.



# MOUNTING THE GRINDING CUP WHEEL TO THE GRINDER

## WARNING!

Make sure the Ecoguard Type G is securely attached to the grinder, otherwise it may come loose, causing injury.

1. Firmly hold Connector Assembly and tighten the screws.

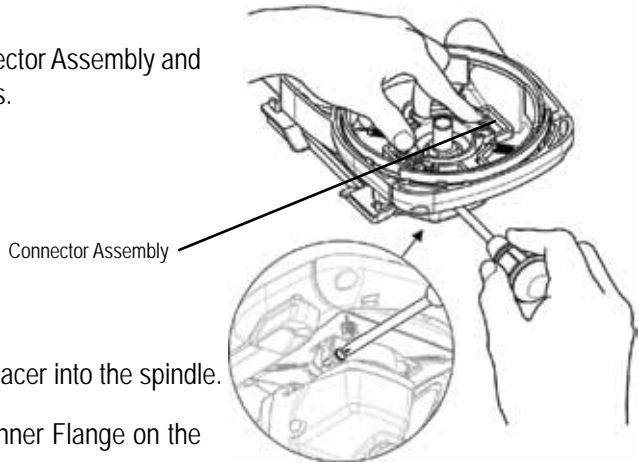



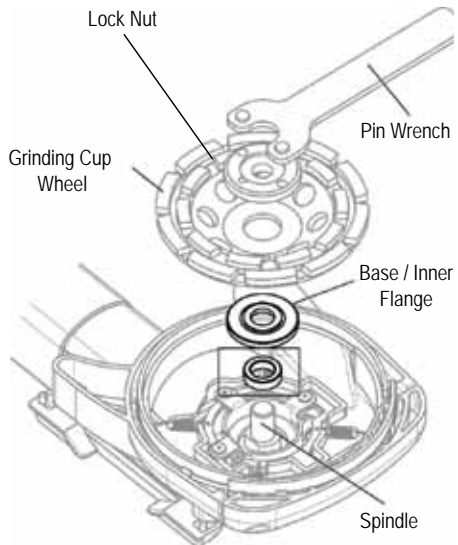

2. Set the proper Spacer into the spindle.
3. Set the Base or Inner Flange on the Spacer.
4. Set the Grinding Cup Wheel on the Base or Inner Flange.
5. Set the Lock Nut on the Grinding Cup Wheel. (Be careful to ensure the correct direction of the Lock Nut)
6. Depress the spindle and tighten the Lock Nut with the Pin Wrench.

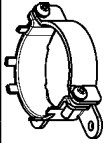
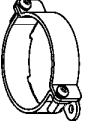
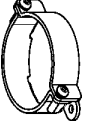

(Fig.6)

## ATTACHABLE GRINDERS FOR ECOGUARD G

BRAND	HITACHI®	DEWALT®	FLEX®	MILWAUKEE®	MAKITA®	BOSCH®	METABO®	
PART NO.	500070	500073	500071	500002	500002	500002	500027	
CONNECTORS				(Factory Preset)				
COLLAR	N/A							
	G12SA3 G12E2 G12SE2P9 G12VA G12SVA G12SR3 G12SS G13SC2 G13SC2P9 G13SP G13VA	DWE4011 DWE4120(N) D28110 D28112 D28402 D28065 D28114 D28115 D28131 D28140 D28144	L3410VRG	6130 6140 6146 6147 6121 6117 6121 6124 6161	GA4030(K) GA4530 GA4534 GA5010Z GA5020(Y) 9554NB 9557NB/PB 9558PB 9564CV/PC 9565CV/PC 9566CV/PC BGA451(Z) BGA452(Z)	1830 Slim	W8-115(O) W8-125(O) W11-125(O) WA11-125(O) WE9-125(O) WE14-125(P) WE14-125 VS WP8-125(O) WPT11-125(O) WEPAT14-125(O) W11-150(O) WE14-150(O) WEP14-150(O) WEPAT14-150(O) WPT11-150(O)	

# GRINDING APPLICATIONS

## ► SURFACE GRINDING

Securely connect the Flexible Connector Hose to the Dust Collection Cover. Turn Grinder and Vacuum on to start grinding application.

Use the Alpha® Rubber Hose Connector as a joint between duct and Flexible Connector Hose.

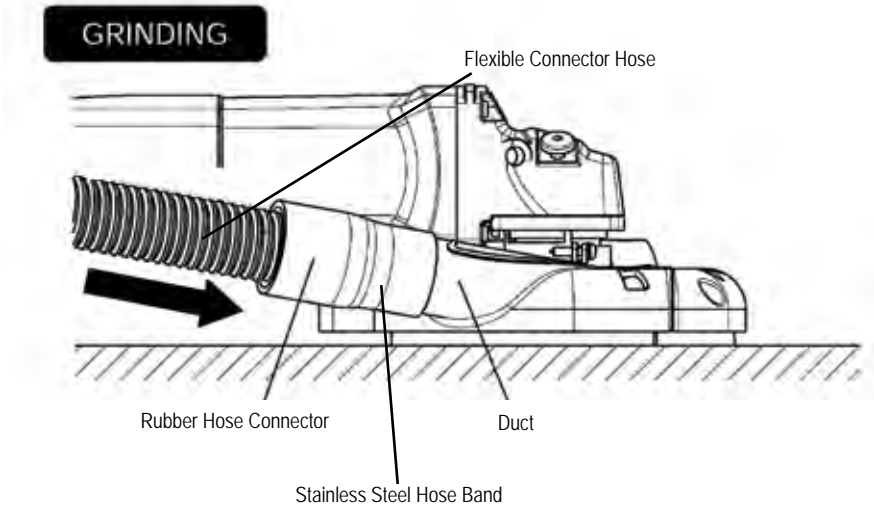

(Fig.7)

► WALL GRINDING

1. Loosen the screws and remove the Sub Cover and Half Cover.

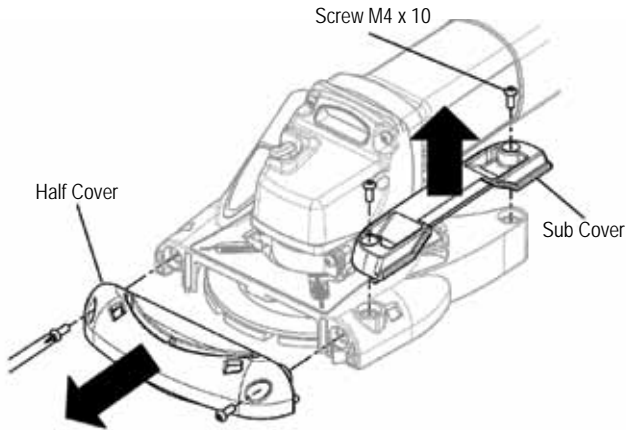

(Fig.8)

2. Switch the position of the Sub Cover and Half Cover.
3. Tighten screws.

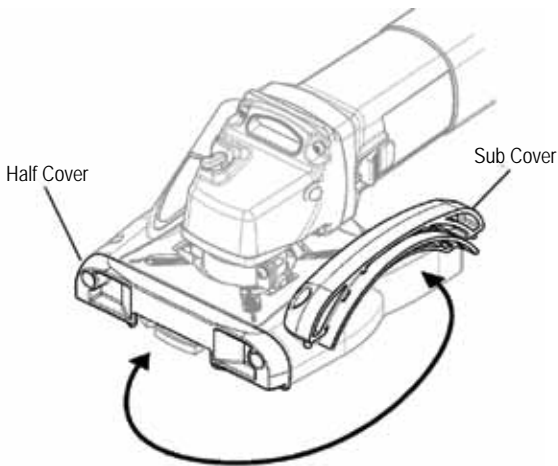

(Fig.9)

## ATTACHING THE DUST COLLECTOR

1. Securely connect Flexible Connector Hose to the duct of the grinder, then turn Grinder and Vacuum Cleaner on to start grinding application.
2. Use an adapter such as the Alpha® Rubber Hose Connector as a joint between the duct and the Flexible Hose Connector.

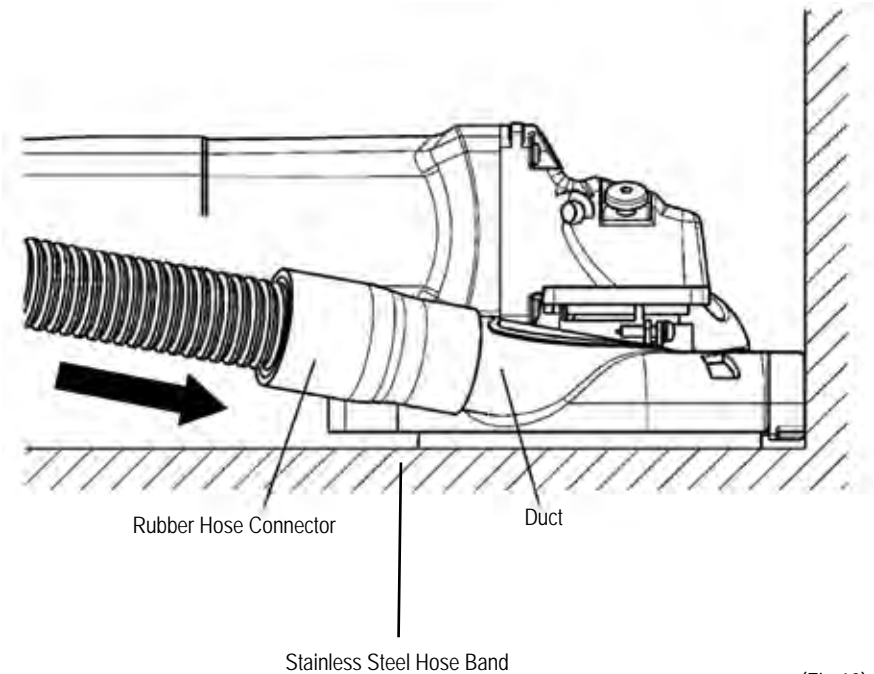

(Fig.10)

# ALPHA® ECOGUARD TYPE G SCHEMATIC

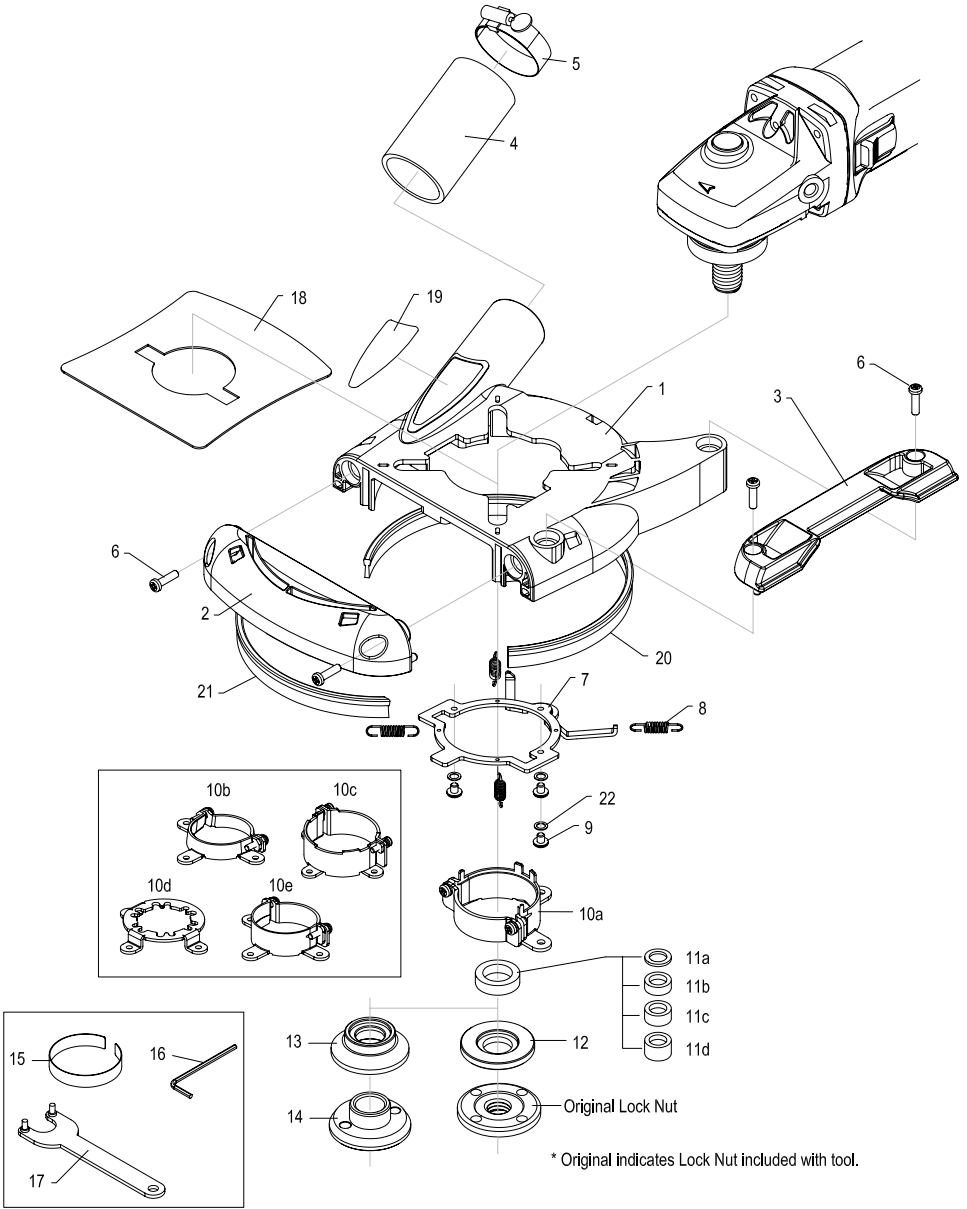

# ALPHA® ECOGUARD TYPE G PARTS LIST

DRAWING NO.	PART NO.	DESCRIPTION	QUANTITY
1	500032	Main Cover	1
2	500033	Sub Cover	1
3	500034	Half Cover	1
4	500005	Rubber Hose Adapter	1
5	500006	Stainless Steel Hose Band	1
6	500037	Screw M4x10	4
7	500038	Set Plate	1
8	500039	Holder Spring	4
9	500020	Flat Head Screw M4x5	3
10a	500028	Connector Assembly (Makita® / Milwaukee® / Bosch®)	1
10b	500003	Connector Assembly (Hitachi®)	1
10c	500004	Connector Assembly (Bosch® / Metabo®)	1
10d	500071	Connector Assembly (Flex®)	1
10e	500073	Connector Assembly (Dewalt®)	1
11a	500011	Spacer-T2.5	1
11b	500012	Spacer-T5.0	1
11c	500013	Spacer-T7.0	1
11d	500014	Spacer-T9.4	1
12a	500029	Base Flange	1
13	500007	Inner Flange	1
14	500008	Lock Nut	1
15	500022	Collar M (Metabo®)	1
16	500024	Hex. Wrench	1
17	210105	Pin Wrench	1
18	500036	Seal	1
19	500040	Bland Label	1
20	500041	Brush (A)	1
21	500042	Brush (B)	1
22	500021	Taper Washer	3
<b>OPTIONAL ACCESSORY:</b>			
Shown on pg 4	500026	Flexible Connector Hose 18"	1



103 Bauer Drive, Oakland, NJ 07436 • 800-648-7229 • Fax: 800-286-0114  
[www.alpha-tools.com](http://www.alpha-tools.com)

Copyright © 2016 Alpha Professional Tools. All rights reserved.

01/2016

---